

spirax sarco®

Thermo-Dynamic® Liquid Drain Trap TDA52

The Thermo-Dynamic® type liquid drain trap cycles periodically, discharging liquid as quickly as it accumulates, so as to prevent harmful back-up.

Model ⇄	TDA52
PMO	250 psig
Sizes	1/2"
Connections	NPT
Construction	stainless steel

Typical Applications

Receiver and air line drainage,
gas line drainage

Limiting Operating Conditions

Max. Operating Pressure (PMO) 250psig(17 barg)

Max. Operating Temperature 800°F (427°C)
Minimum pressure for satisfactory operation is 50 psi (3.5 bar) Maximum back pressure should not exceed 80% of the inlet pressure under any conditions of operation, otherwise the trap may not shut.

Pressure Shell Design Conditions

PMA 600 psig/0-800°F 42 barg/0-427°C
Max. allowable pressure

TMA 800°F/0-600 psig 427°C/0-42 barg
Max. allowable temperature

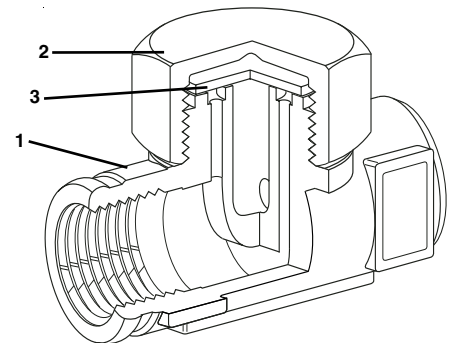

Construction Materials

No.	Part	Material	
1	Body	Stainless Steel	AISI 420F
2	Cap	Stainless Steel	AISI 416
3	Disc	Stainless Steel	AISI 420

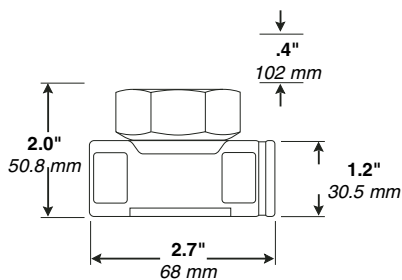

Weight
.9 lb
0.41 kg

Capacities

Pounds of water per hour continuous discharge to atmosphere

Inlet Pressure psig	bar	1/2" TDA52
50	3.5	1140
75	5.2	1400
100	6.9	1650
150	10.3	2050
200	13.8	2400
250	17.2	2800

For kg/hr, multiply lb/hr by .454

Local regulation may restrict the use of this product below the conditions quoted. Limiting conditions refer to standard connections only.
In the interests of development and improvement of the product, we reserve the right to change the specification.

TI-7-314-US 11.00

Thermo-Dynamic® Liquid Drain Trap TDA52

Sample Specification

Drain trap shall be all stainless steel Thermo-Dynamic® type with connections on a common center line. Integral seat design with hardened disc and seating surfaces, Spirax Sarco type TDA52 for all pressures from 50 psig 250 psig.

Installation

The trap should be installed in a vertical position (discharging downward) as close as possible to the equipment being drained. The discharge should be piped to a safe place.

Maintenance

This product can be maintained without disturbing the piping connections. Complete isolation of the trap from both supply and return line is required before any servicing is performed.

The trap should be disassembled periodically for inspection and cleaning of the seat and disc.

Worn or damaged parts should be replaced using a complete repair kit.

Complete installation and maintenance instructions are given in the IMI sheet which accompanies the product.

Liquid drain traps can be used to drain most liquids from most gases. However, some applications, particularly those involving hazardous or unusual fluids, may be subject to regulation or may otherwise require special consideration. Spirax Sarco will endeavor to provide whatever data is necessary to assist in product selection.

Spare Parts

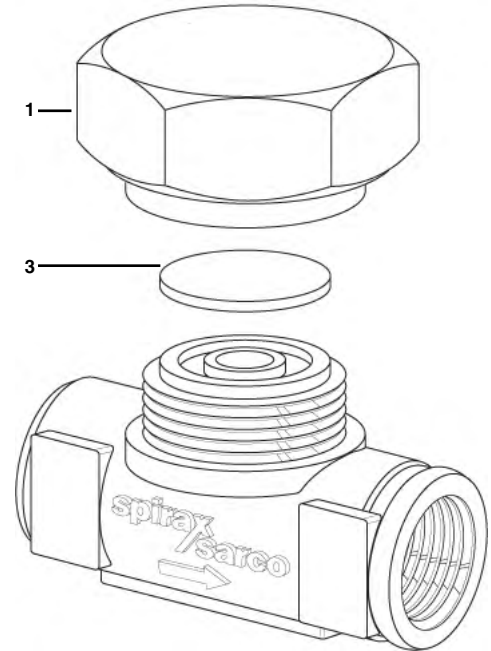

Disc	3
Cap	1