



TI-S01-04-US
Issue 1

Mod. 2000 Self Drainage Unit For Float and Thermostatic Trap to prevent freeze up

Description

The drainage device is to be used on the bottom drain connection on Float and Thermostatic steam traps or drain traps in outdoor installations where freezing may occur.

When the pressure drops below 3 psi g (0.21 bar g) the device opens to completely drain the trap body. The unit will close at pressures above 3 psi g (0.21 bar g).

Model	Mod. 2000
PMO	464 psi g (32 bar g)
Size	$\frac{3}{8}$ "
Connections	NPT
Construction	Tamperproof stainless steel

Pressure shell design conditions

PMA	Maximum Allowable Pressure	464 psi g	(32 bar g)
TMA	Maximum Allowable Temperature	482 °F	(250 °C)
PMO	Maximum Operating Pressure	464 psi g	(32 bar g)
PMO	Maximum Operating Temperature	482 °F	(250 °C)
Minimum Closer Pressure		3.6 psi g	(.25 bar g)
Opening pressure		3 psi g	(0.2 bar g)

Materials

No.	Part	Material
1	Sleeve	Stainless Steel
2	Body with integral seat	
3	Ball valve	
4	Spring	

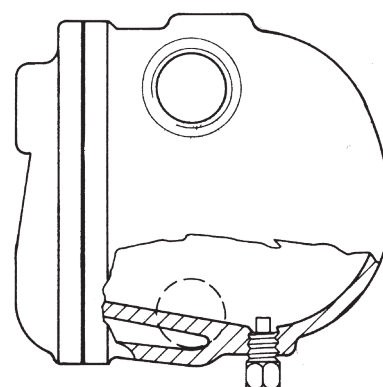

Float and Thermostatic style steam trap with Mod. 2000 drainage device

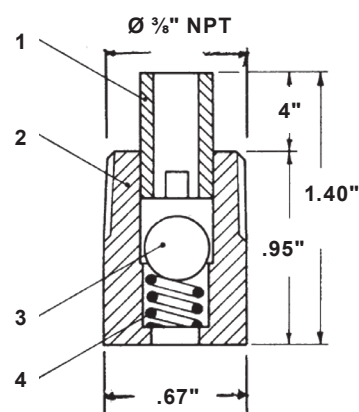

Installation

Thread the Mod. 2000 into the drain connection on the bottom of the F&T trap. Most, but not all, have $\frac{3}{8}$ " connections. Bush down to $\frac{3}{8}$ " NPT if connection on the trap is larger.

This device will automatically open and drain when the steam trap pressure drops below 3 psi g; so, it should not drain in an area where it could dump hot condensate onto personnel.

If the trap is where drainage may cause a danger, an open funnel drain with a 1" air gap should be placed under the Mod.2000 to drain condensate to a safe place.

Reference IM-2-323-US.