



IPC20 and IPC21 Pipeline Connectors with Integral Spiratec Sensors (Requires Universal Trap of choice)

Description

The **IPC20** is a pipeline connector with integral strainer and Spiratec sensor for use with UTD52L, UTD52H, UTD30L, UTD30H and UBP32 steam traps.

The **IPC21** is a pipeline connector with an integral strainer and Spiratec sensor for use with UIB30, UIB30H, UFT14 and UFT32 steam traps.

Both the **IPC20 and IPC21** can be fitted with the following sensor options:

SSL1 Sensor - for detection of steam leakage.

WLS1 sensor with diode - for use with R16C monitor to detect steam wastage and waterlogging.

WLS1 sensor without diode - for use with R1C to detect steam wastage and waterlogging.

Model	IPC20 and IPC21 Series
PMO	Dependent on trap type
Sizes	1/2", 3/4", 1"
Connections	NPT Standard
Construction	Stainless steel
Options	SW connections to ANSI B16.11 BSP

SSL1 Sensor shown

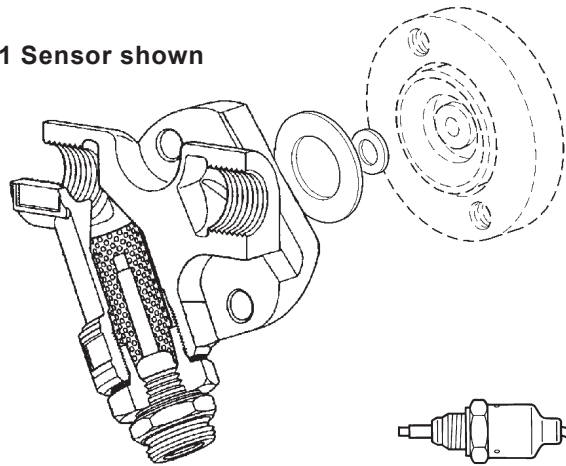

Waterlogging sensor WLS1

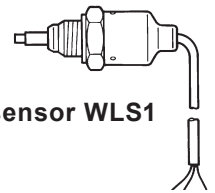

SSL1 Standard sensor

used with type 30 meter, R1C and R16C
 R1C and R16C required a PT1, PT2, or PT3.
 Plug tails are ordered separately

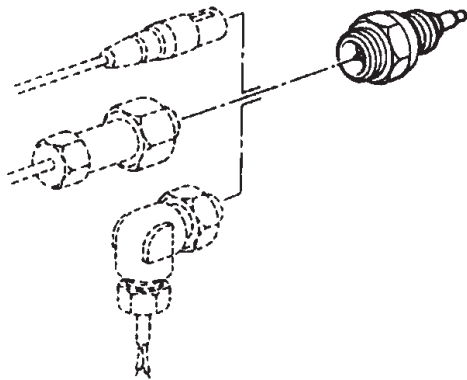

WLS1 Waterlogging sensor assembly

used with RIC and R16C
 WLS1 requires diode pack

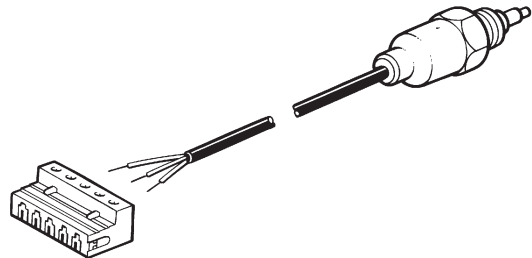

Limiting operating conditions

PMO	Maximum operating pressure	464 psi g (32 bar g) connector only Trap may dictate actual PMO if lower when assembled (See trap TIS sheet)
TMO	Maximum operating oemperature	464 °F (240 °C)

Pressure shell design conditions

PMA	Maximum allowable pressure	725 psi g (50 bar g) connector only Trap when mounted to connector may dictate PMA if lower (See Trap TIS sheet)
TMA	Maximum allowable temperature	464°F (240 °C) Selected trap may lower these values.

Operating range

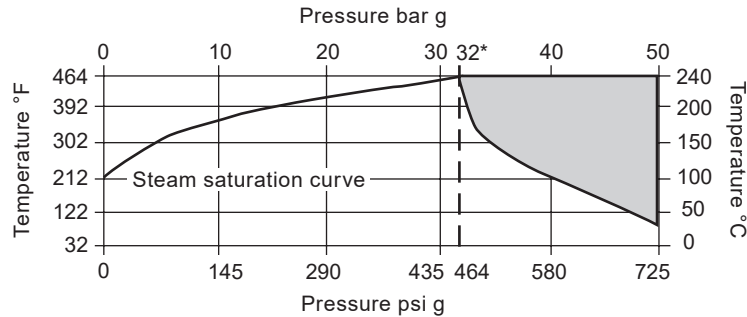

The product **must not** be used in this region.

Materials

No.	Part	Material	
1	Body	Austenitic stainless steel	ASTM A 351 CF8
2	Strainer screen	Austenitic stainless steel	316L (0.8 mm perforations)
3	Strainer cap	Austenitic stainless steel	AISI 303
4	Cap gasket	Stainless steel	BS 1449 304 S16
5	Sensor	Stainless steel	ASTM A582 416
6	Sensor gasket	Stainless steel	
Selected trap (see trap TIS)			
7	UTD52L, H, HP	TIS 2.5161	
	UTD30L & H	TIS 2.517	
	UFT32	TI-P146-02 US	
	UIB30. 30H	TIS 2.412	
	UBP32	TIS 2.0008	

(Trap of choice sold separately)

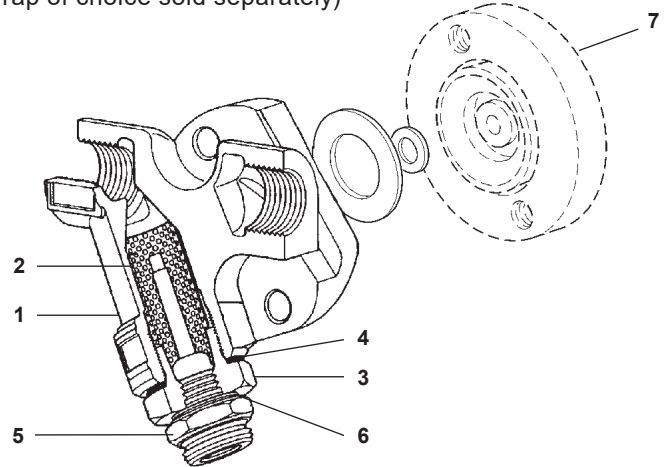

SSL1 Sensor shown

Dimensions/weights (approximate) in inches (mm) and lbs (kg)

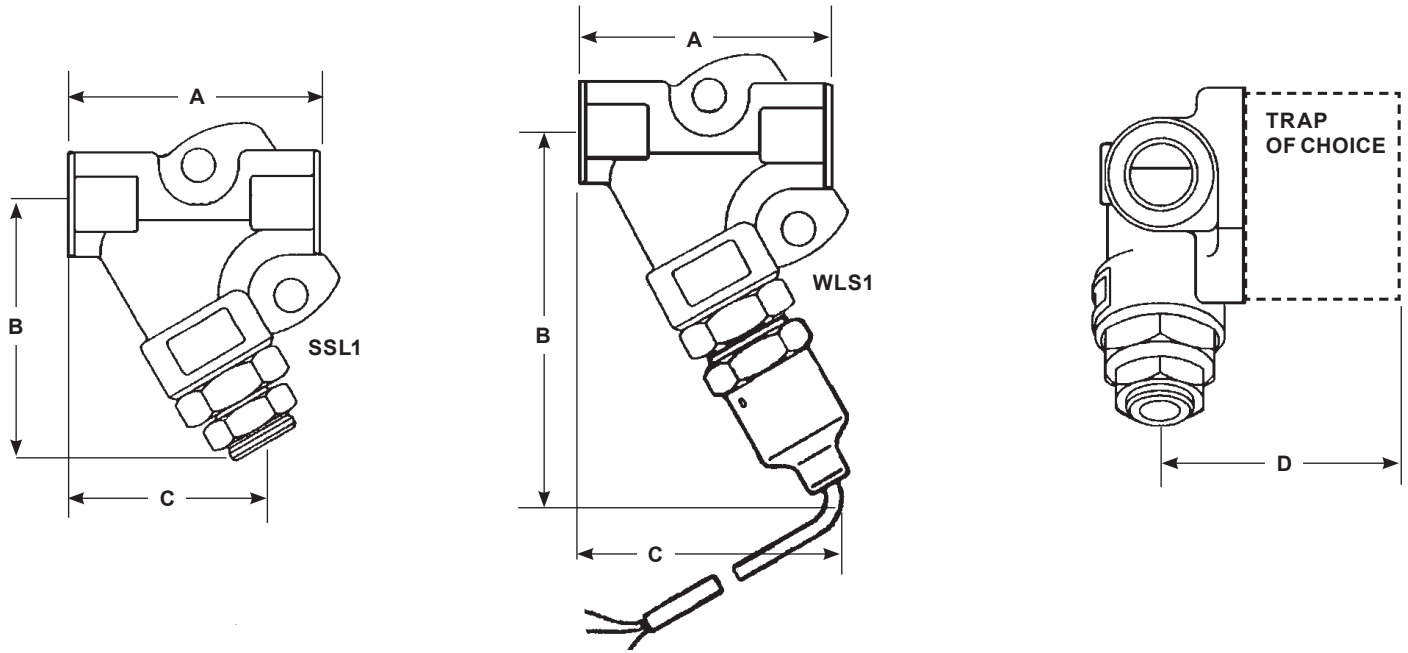

SSL1 SENSOR IN PC 20 OR 21 CONNECTOR

Size	A	B	C	Sensor B	Withdraw C	PT1/Type 30	PT1/Type 30	PT2	PT2	PT3	PT3	Weight Connector only
						plug tail withdraw B	plug tail withdraw B	plug tail withdraw B	plug tail withdraw C	plug tail withdraw B	plug tail withdraw C	
1/2"	3.2	3.1	2.6	4.9	3.6	5.6	3.5	5.8	4.13	4.8	3.5	2.7
	81	79	66	124	91	142	89	147	105	122	89	1.2
3/4"	3.5	3.2	2.7	5	3.7	5.7	4.1	5.9	4.3	4.9	3.7	2.9
	89	81	69	127	94	145	104	150	109	124	94	1.3
1"	3.9	3.4	2.9	5.1	3.9	5.9	4.3	6.1	4.5	5.1	3.9	3.3
	99	86	74	130	99	150	109	155	114	130	99	1.5

WLS1 SENSOR IN PC 20 OR 21 CONNECTOR

Size	A	B	C	Sensor B	Withdraw C	Weight Connector only
1/2"	3.2	5	3.6	6.7	4.6	2.7
	81	127	91	170	117	1.2
3/4"	3.5	5.1	3.8	6.8	4.8	2.9
	89	130	97	173	122	1.3
1"	3.9	5.2	4.0	7.0	5.0	3.3
	99	132	102	178	127	1.5

WLS1 SENSOR IN PC 20 OR 21 CONNECTOR

Size	UTD52L	UTD52H	UFT14	UBP32	UIB30	UIB30H
	D	D	D	D	D	D
1/2"	3.3	3.8	7.3	2.2	5.0	6.0
	84	97	185	56	127	152
3/4"	3.3	3.8	7.3	2.6	4.9	6.0
	84	97	185	66	124	152
1"	3.4	3.8	7.3	3.3	5.0	6.3
	86	97	185	84	127	160

Installation

The connector will be installed in a horizontal pipeline. The connector face must be in a vertical plane with the Sensor in a downward position. Full ported isolation valves should be installed up stream and down stream of the connector. The trap should be fitted to the connector with its cap uppermost or as shown in the related trap IMI. Note each trap type will have its own IMI.

Maintenance

The sensor should be removed periodically to inspect and clean the tip and insulator.

Sample Specification

Connector shall be supplied with either a SSL1 steam loss only or WLS1 steam loss and water logging sensor. The connector with integral sensor will be made in sizes ½" to 1" in stainless steel with NPT, BSP or SW connections. The connector shall be capable of working with any of the Spirax Sarco universal connector steam traps. The SSL1 Sensor will work with TYPE 30, R1C, R16C. The WLS1 will work with the R1C and the R16C. The connector is designed to remain in line with the trap and sensor easily removable without disturbing the piping.

Spare Parts

The spare parts available are detailed below. No other parts are supplied as spares.

Available spares

Sensor and sensor gasket (Sensor gasket package of 10)	A, B
Hydrostatic blind flange test kit	D



How to order spares

Always order spares using the description given in the column headed 'Available spares' state the size and model number.

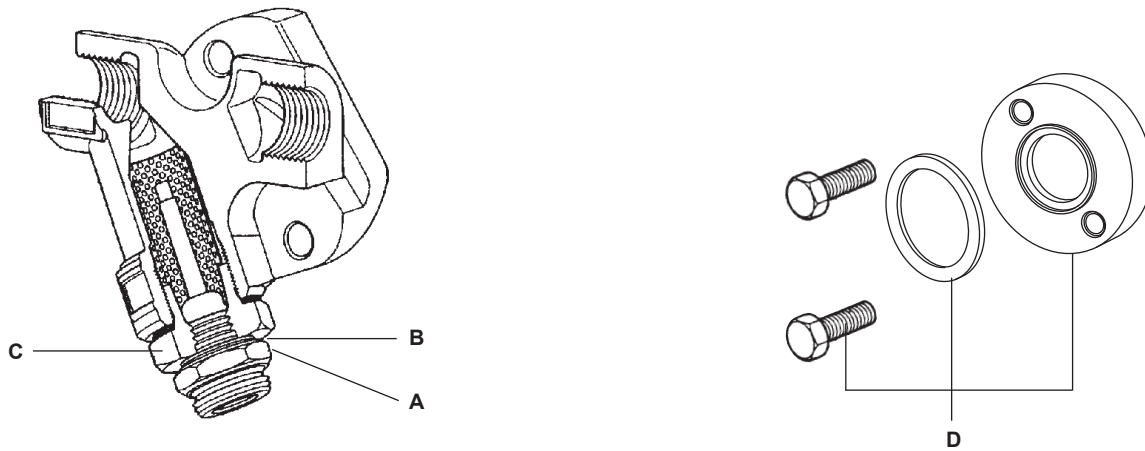
Example: 1 - Strainer screen and gasket for the ½" IPC20 connector.



Recommended tightening torques

Item	 or mm		Ft/Lbs
C	32 A/F	M28 x 1.5P	125 - 140
A	24 A/F		37 - 41