



Cast Iron Strainers CI-125

Description

Type	CI-125	
Sizes	2" to 4"	6"
Connections	ANSI 125	
Construction	Cast Iron	
Maximum saturated steam pressure	147 psi g	125 psi g
Standard screen	20 Mesh	4" to 8" 1/8" perf
Options	60/100 mesh	100 Mesh 4" to 6" 3/64" perf
	Steel or Brass Plug	

Note: Conforms to WW-S-2739 when equipped with an optional bronze plug in the blow-off connection.

Cv Values

Size	Cv
2"	70
2½"	110
3"	165
4"	280
5"	450
6"	650

For water:

$$\text{Pressure Drop} = \frac{(\text{GPM})^2}{(\text{Cv})^2}$$

Consult factory for other liquids.

See TI-S26-04-US for pressure drops on steam, air and other gases.

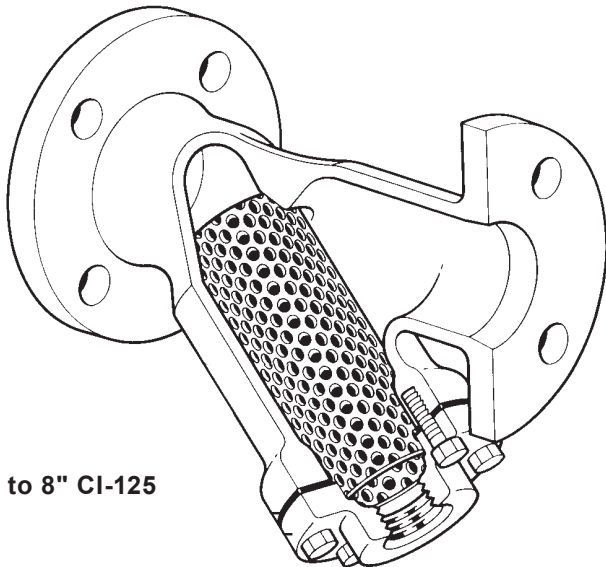

2½" to 8" CI-125

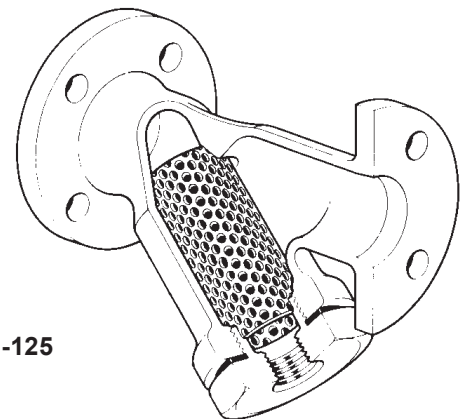

2" CI-125

Materials

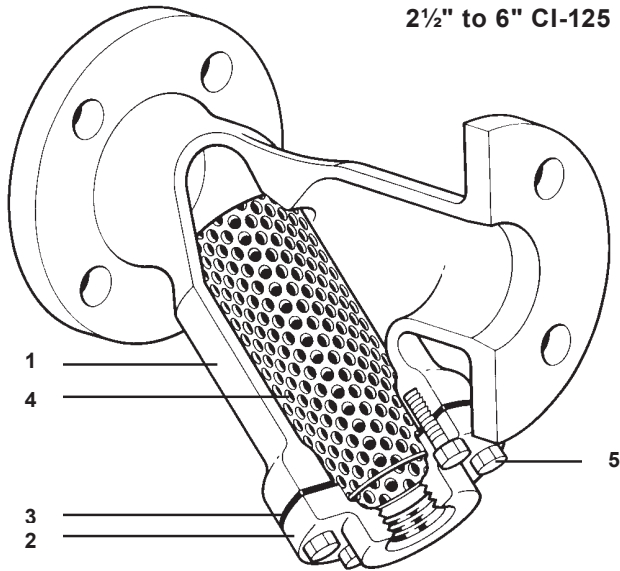

2 1/2" to 6" CI-125

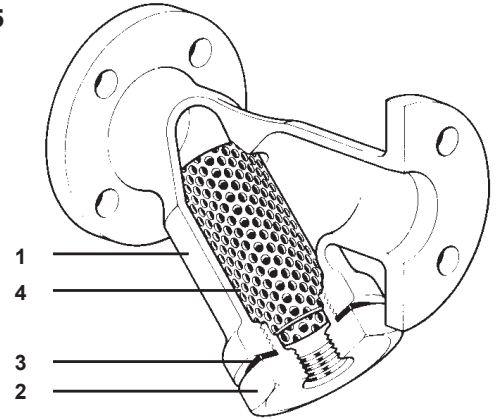

2" CI-125

Blowdown offset on sizes 4" - 6"

No.	Part	Material	
1	Body	Cast Iron	ASTM A126 CLB
2	Cap/Bushing	Cast Iron	ASTM A126 CLB2
3	Cap Gasket	*Graphite	
4	Strainer Screen	Stainless Steel	
5	Cap Screws	Steel	

*2" – Copper Jacketed Gasket with Non-Asbestos Filler

Pressure shell design conditions

Maximum allowable pressure	200 psi g/-20-150 °F	(14 bar g/-29-66 °C)
Maximum allowable temperature	450 °F/0-125 psi g	(232 °C/0-9 bar g)

Limiting operating conditions (non-shock)

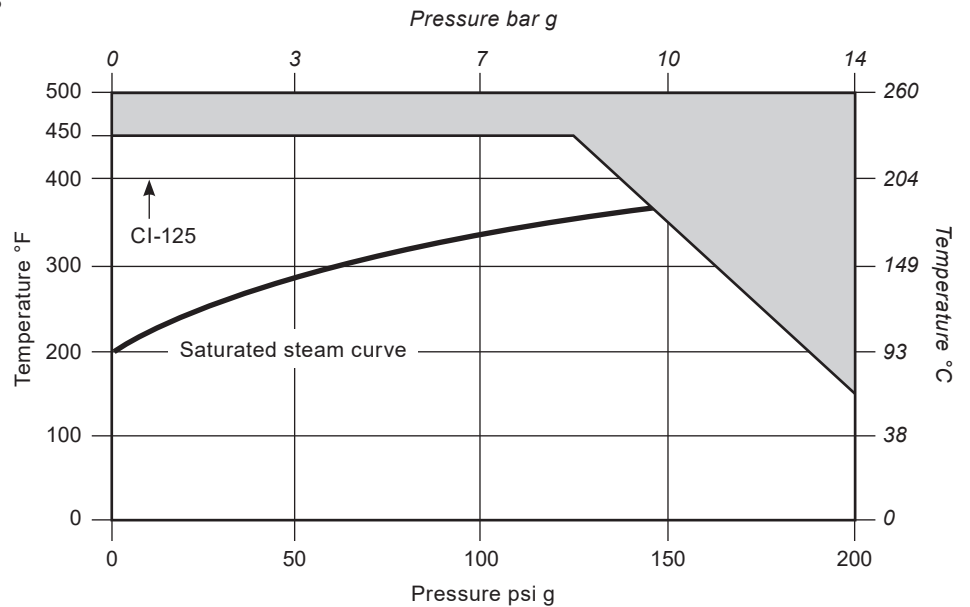

Dimensions/weights

(approximate) in inches (mm) and lbs (kg)

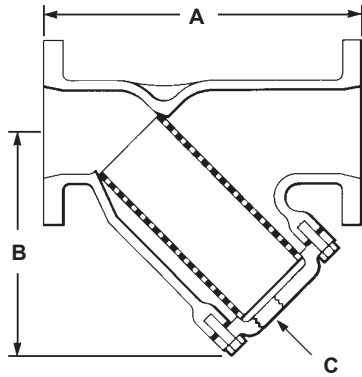

Blowdown
connectors
offset on sizes
4" - 6"

Size	A	B	C (NPT)	Weight
2"	8.7	5.7	1"	17 lb
	222	146		7.7 kg
2½"	10.5	6.7	1¼"	29 lb
	267	171		13 kg
3"	12.0	7.6	1¼"	44 lb
	305	194		20 kg
4"	14.9	10.6	1¼"	82 lb
	378	270		37 kg
5"	17.2	12.9	1½"	115 lb
	438	327		52 kg
6"	20.0	15.4	1½"	160 lb
	508	391		73 kg

Installation

The strainer should be installed with the flow direction as indicated on the body, in a vertical down or horizontal pipeline. The strainer must be accessible for periodic removal of accumulated debris, by either blowing down or removal and cleaning of the screen.

Spare parts

Screen (state material, perforations or mesh and size of strainer)	C
Cap Gasket	B
Blowoff Bushing, 2"	A
Cap	A

Note:

Please provide date code when placing order for spare parts. Contact Technical Support for assistance if needed.

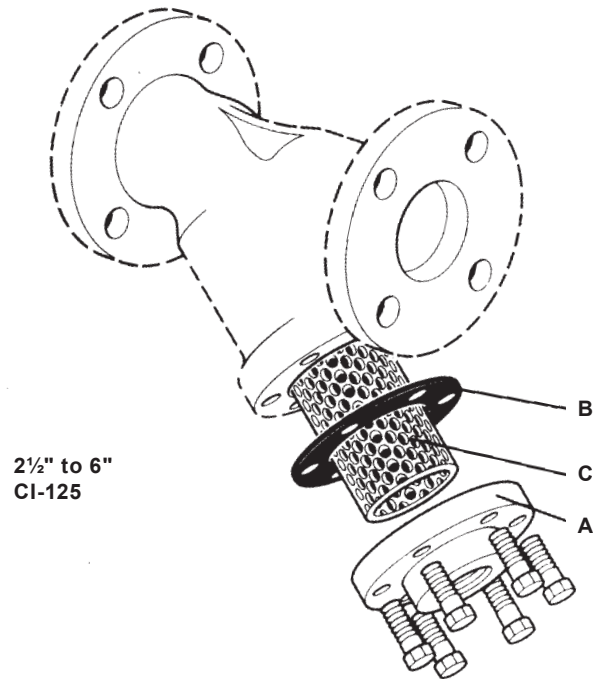

2" CI-125 only

