

# spirax sarco

## S12 SG Iron Separator (Screwed)

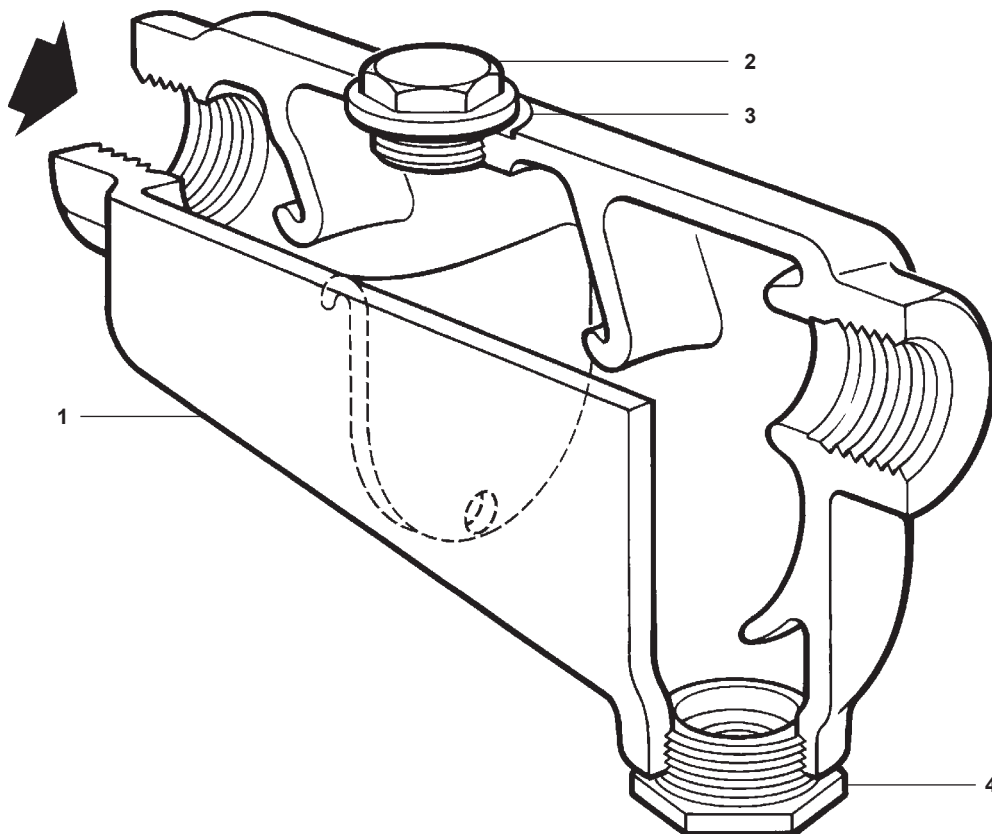

### Description

The S12 separator is an SG iron baffle type separator used for the removal of entrained liquids in steam, compressed air or gas systems. The fitting of insulation jackets will increase the performance of the separator.

### Standards

This product fully complies with the requirements of the Indian Boiler Regulations, 1950.

### Certification

This product is available with a manufacturers' Typical Test Report and IBR certification. **Note:** All certification/inspection requirements must be stated at the time of order placement.

### Sizes and pipe connections

1¼", 1½" and 2" screwed BSP with screwed BSP drain or  
 1¼", 1½" and 2" screwed NPT with screwed NPT drain.

### Materials

No.	Part	Material	
1	Body	SG iron	DIN 1693 GGG40/ ASTM A395
2	Plug (2" only)	Carbon steel	1.0460 (C22.8)
3	Gasket (2" only)	Reinforced exfoliated graphite	
4	Drain reducing bush	Forged carbon steel	ASTM A105

### Pressure/temperature limits (ISO 6552)

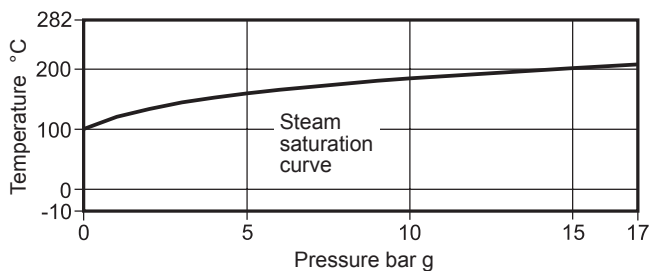



Body design conditions	17.5 bar g
PMA Maximum allowable pressure	17 bar g @ 282 °C
TMA Maximum allowable temperature	282 °C @ 17 bar g
Minimum allowable temperature	-10 °C
PMO Maximum operating pressure for saturated steam service	17 bar g
TMO Maximum operating temperature	282 °C @ 17 bar g
Minimum operating temperature	-10 °C
<b>Note:</b> For lower operating temperatures consult Spirax Sarco.	
Designed for a maximum cold hydraulic test pressure of: 25.5 bar g	

## Dimensions, weights and volumes (approximate) in mm, kg and litres

Size	A	B	C	D	E	F	G	Weight	Volume
1¼"	111	156	89	304	½"	1"	60	9.0	1.5
1½"	111	156	89	304	½"	1"	60	9.0	1.5
2"	146	205	117	397	½"	1"	71	17.0	3.2

## Recommended tightening torques

Item	Size	 or  mm	N m
2	2"	46 A/F M56	150 - 165

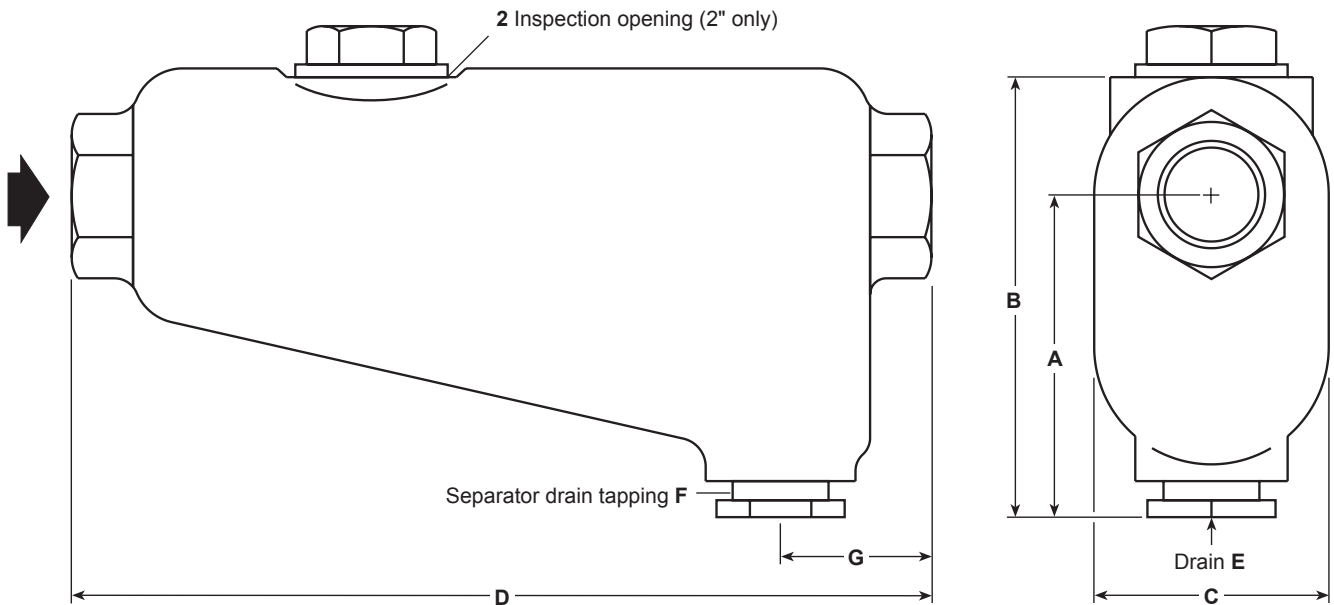

## Safety information, installation and maintenance

For full details see the Installation and Maintenance Instructions (IM-IBR16-19IN) supplied with the product.

### Installation note:

Install in a horizontal pipeline with the drain directly below. **Note:** To ensure that any separated liquid is drained away quickly, a suitable liquid drainer or steam trap must be connected to the drain connection 'E' - consult Spirax Sarco for further details.

### Disposal

This product is recyclable. No ecological hazard is anticipated with the disposal of this product, providing due care is taken.

## How to order

**Example:** 1 off 2" Spirax Sarco S12 separator with SG iron body having screwed BSP connections.