

HV412A / HV422A Stop Globe Valve - PN63/PN100

Description

The globe valve is designed to open and stop the flow. The valve is not supposed to be used as a regulating device.

Medium: water, steam and other non-toxic, non-aggressive liquid and gas media.

Sizes and pipe connections

DN15 to DN200.

HV412A: Flanged according to EN 1092 PN63

HV422A: Flanged according to EN 1092 PN100

On special request: Butt Weld.

Standards

The product fully complies with the requirements of the European Pressure Equipment Directive 2014/68/EU and carries the mark CE when so required.

Certification

The HV412A / HV422A are available with certification to EN 10204 3.1.

Note: All certification / inspection requirements must be stated at the time of order placement.

Pressure / temperature limits

HV412A	
Body Design Conditions	PN63
Maximum allowable pressure	63 barg
Maximum allowable temperature DN15 - 40	560°C
Maximum allowable temperature DN50 - 200	550°C
HV422A	
Body Design Conditions	PN100
Maximum allowable pressure	100 barg
Maximum allowable temperature DN15 - 40	560°C
Maximum allowable temperature DN50 - 200	550°C



Construction

Part	Material
Body	Alloy steel DN15 – 40
	Alloy steel DN50 – 200
Seat ring	Stainless steel G 18 8 Mn
Disc	Alloy Steel 13CrMo4-5
Disc ring	Stainless steel G 18 8 Mn
Stem	Stainless steel X39CrMo17-1
Gasket	Graphite / Stainless steel
Handwheel	Cast iron

Technical data

HV412A		Maximum working pressure (in barg) @ working temperature																	
Body mat.	PN	20°C	100°C	150°C	200°C	250°C	300°C	350°C	400°C	450°C	480°C	500°C	510°C	520°C	530°C	540°C	550°C	560°C	
13CrMo4-5	63	63,0	63,0	63,0	63,0	63,0	62,7	60,0	57,0	54,0	46,2	41,1	34,6	28,2	23,4	18,3	14,7	12,0	
G17CrMo5-5	63	63,0	63,0	63,0	63,0	63,0	63,0	63,0	60,0	43,5	31,9	24,3	21,5	18,8	16,0	13,3	10,5	-	

HV422A		Maximum working pressure (in barg) @ working temperature																	
Body mat.	PN	20°C	100°C	150°C	200°C	250°C	300°C	350°C	400°C	450°C	480°C	500°C	510°C	520°C	530°C	540°C	550°C	560°C	
13CrMo4-5	100	100,0	100,0	100,0	100,0	100,0	99,5	95,2	90,4	85,7	73,4	65,2	54,9	44,7	37,1	29,0	23,3	19,0	
G17CrMo5-5	100	100,0	100,0	100,0	100,0	100,0	100,0	100,0	95,2	69,1	51,8	38,6	34,2	29,8	25,4	21,1	16,7	-	

Dimensions & weights (approximative) in mm / kg

HV412A														Flanged				Butt Weld			
DN	D	Dz	Dp	Do	do	n	L	g	f	H	h	Dk	Weight	Dz	Dw	L	Weight				
15	14	105	45	75	14	4	210	20	2	160	13	120	5,4	22	17	160	3,0				
20	19	130	58	90	18	4	230	22	2	160	13	120	9,8	28	22	160	3,0				
25	23	140	68	100	18	4	230	24	2	160	13	120	10,8	35	28,5	160	3,0				
32	30	155	78	110	22	4	260	24	2	210	16	160	15,0	44	36,5	230	9,3				
40	38	170	88	125	22	4	260	28	3	210	18	160	15,7	50	43	230	9,5				
50	45	180	102	135	22	4	300	26	3	250	22	200	30,7	62	54	300	19,9				
65	62	205	122	160	22	8	340	26	3	290	30	250	46,0	77	69	340	30,9				
80	73	215	138	170	22	8	380	28	3	300	40	320	62,0	91	81	380	48,7				
100	94	250	162	200	22	8	430	30	3	500	55	360	121,5	117	104	430	95,1				
125	120	295	188	240	26	8	500	34	3	600	65	400	168,0	144	130,5	500	137,9				
150	144	345	218	280	33	8	550	36	3	700	70	500	251,0	172	156,5	550	201,1				
200	195	415	285	345	36	12	650	42	3	900	100	600	290,0	223	204,5	650	215,0				

HV422A														Flanged				Butt Weld			
DN	D	Dz	Dp	Do	do	n	L	g	f	H	h	Dk	Weight	Dz	Dw	L	Weight				
15	14	105	45	75	14	4	210	20	2	160	13	120	5,4	22	17	160	3,0				
20	19	130	58	90	18	4	230	22	2	160	13	120	9,8	28	21,5	160	3,0				
25	23	140	68	100	18	4	230	24	2	160	13	120	10,8	35	28,5	160	3,0				
32	30	155	78	110	22	4	260	24	2	210	16	160	15,0	44	36	230	9,3				
40	38	170	88	125	22	4	260	28	3	210	18	160	15,7	50	43	230	9,5				
50	45	195	102	145	26	4	300	28	3	250	22	200	30,7	62	54	300	19,9				
65	62	220	122	170	26	8	340	30	3	290	30	280	46,0	77	69	340	30,9				
80	73	230	138	180	26	8	380	32	3	300	40	360	62,0	91	81	380	48,7				
100	94	265	162	210	30	8	430	36	3	500	55	360	121,5	117	104	430	95,1				
125	120	315	188	250	33	8	500	40	3	600	65	400	168,0	144	127	500	137,9				
150	144	355	218	290	33	12	550	44	3	700	70	500	251,0	172	154	550	201,1				
200	195	430	285	360	36	12	650	52	3	900	100	600	295,0	223	199,5	650	218,0				

DN 15 ÷ 40

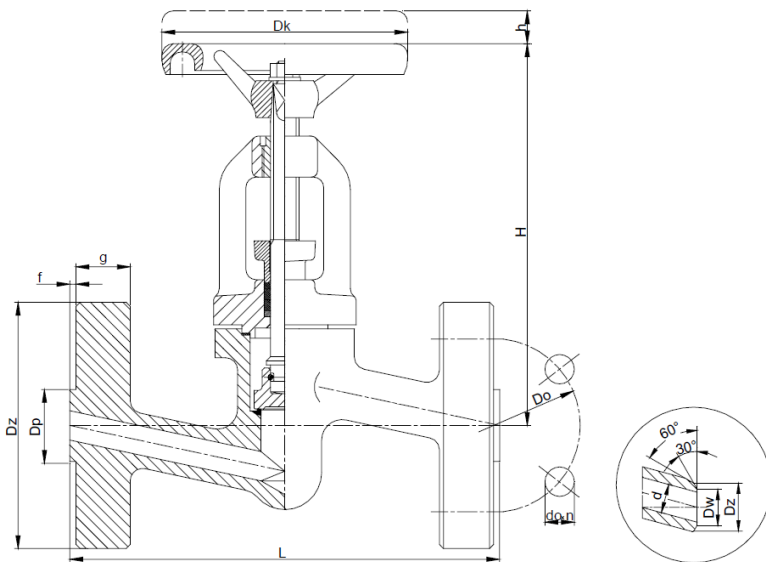

DN 50 ÷ 200

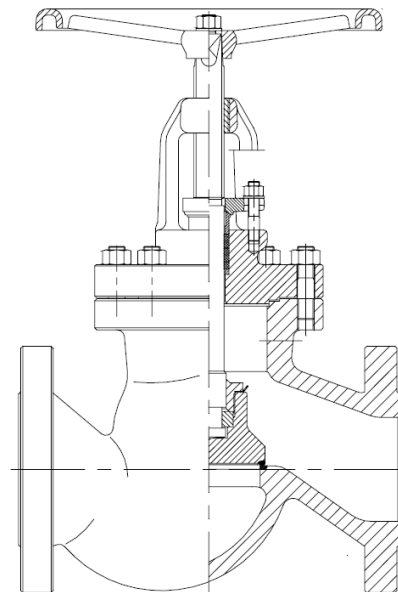

Installation instructions

The valve can only be mounted and operated by skilled, properly trained and qualified personnel.

Incorrect assembly or operation of the valve may have substantial impact on the entire system such as fluid leakage, reduction in system's function etc.

Before a valve is installed the pipeline must be clean from any mechanical impurities. The compatibility of critical parameters of the flow must be checked with the parameters of the valve.

The stop globe valve can be mounted in a pipeline in any position. The direction of flow should be in-line with the arrow marked on the body. The valve should be operated strictly as it's intended. To provide the valve's reliability, the following suggestions must be observed:

- Medium flowing through the valve is supposed to be cleaned out of any mechanical impurities.
- The valve must be protected from any mechanical damages while it's functioning
- Nominal parameters marked on the valve must be observed.