



BSP Pressure Gauge with Needle Valve and Syphon - Food+

Description

Pressure gauge with 100 mm diameter dial with units marked in bar, psi and inches hg for vacuum as appropriate and having a BSPP connection. The gauge is supplied with either:

- Ring type syphon tube and Needle Valve.

Available pressure range

	Range	0 to 6.0 bar	0 to 87 psi
Stainless steel	Range	0 to 10.0 bar	0 to 145 psi
	Range	0 to 16.0 bar	0 to 230 psi

Standards

The product fully complies with the requirements of the EU Pressure Equipment Directive/UK Pressure Equipment (Safety) Regulations.

This pressure gauge conforms to:

- DIN EN 837-1:1997-02 Pressure gauges - Part 1: Bourdon tube pressure gauges; dimensions, metrology, requirements and testing,
and
- DIN EN 837-1:1997-02 Pressure gauges - Part 3: Diaphragm and capsule pressure gauges; dimensions, metrology, requirements and testing

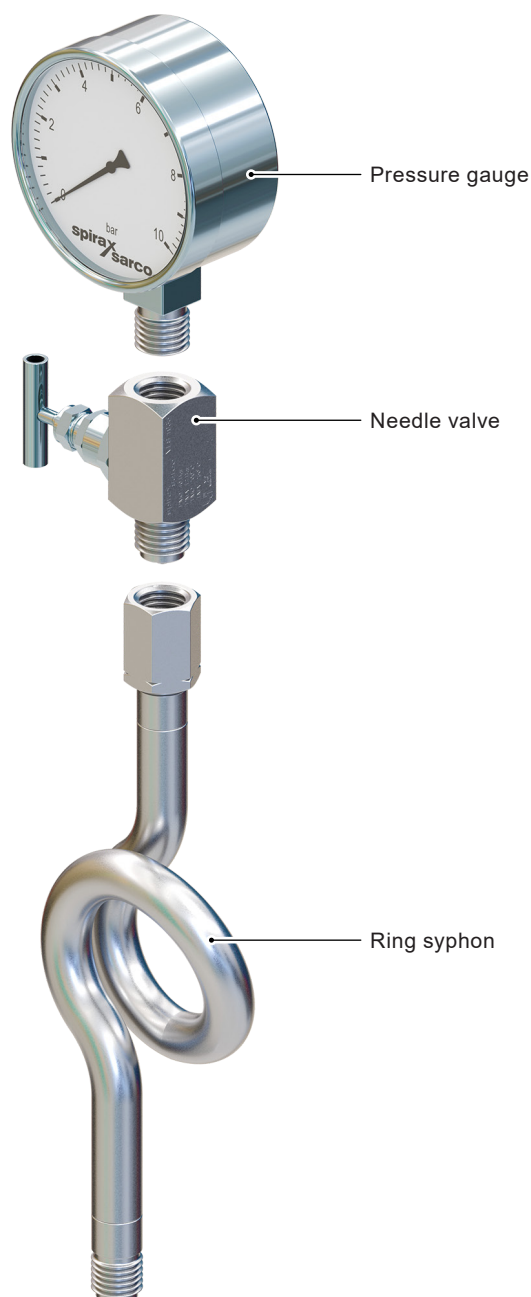

Food+ EC1935

Designed, manufactured and approved for Steam and Condensate applications, the Gauge, Needle Valve and Syphon Food+ products comply with:

- (EC)1935:2004 Materials and Articles Intended to come into Contact with Food.
- (EC)2023:2006 Good Manufacturing Practice for Materials and Articles Intended to come into Contact with Food.
- (EU)10/2011 Plastic Materials and Articles Intended to come into Contact with Food.

This product is intended to be connected into a system that can operate a food contact compliant process.

A list of the materials that could come directly or indirectly into contact with foodstuffs can be found in the Declaration of Compliance available for this product.

Food+ FDA

- FDA Code of Federal Regulations - title 21 - Food and Drugs.

Certification

A certificate of conformity is available as standard for this product. A calibration certificate is available by special order at extra cost.

Sizes and pipe connections

Pressure gauge		G ½" B Male	EN ISO 228-1
Needle valve	Gauge end	½" BSPP female	EN ISO 228-1
	Syphon end	½" BSPP male	EN ISO 228-1
Ring/syphon	Cock end	G ½", LH-RH adjusting nut	DIN 16283
	Process end	G ½" B Male	EN ISO 228-1

Materials

Stainless steel	Gauge	Case	Stainless steel 316TI
		Glass	Snap-fit perspex
		Bourdon tube	Stainless steel 316TI
	Ring syphon		Stainless steel 316L
	Needle valve	Use a Spirax Sarco ½" BSPP VLS 1935	Stainless steel 316L

Pressure/temperature limits

Maximum design conditions			Full scale reading
PMA	Maximum allowable pressure		Full scale reading
TMA	Maximum allowable temperature of gauge.		200 °C
	Minimum allowable temperature		-40 °C (-20 °C Needle Valve)
	Maximum operating pressure	Range	6 bar 86 psi
PMO	Please note: 1. For compressed air and steam services the maximum operating pressure for this product is 16 bar g. 2. Needle valve limited to 12 bar g.	Range	10 bar 145 psi
		Range	16 bar 230 psi
	Maximum ambient temperature		60 °C

Dimensions/weights (approximate) in mm and kg

Gauge				
A	B	C	D	Weight
100	29	137	22 A/F	0.43

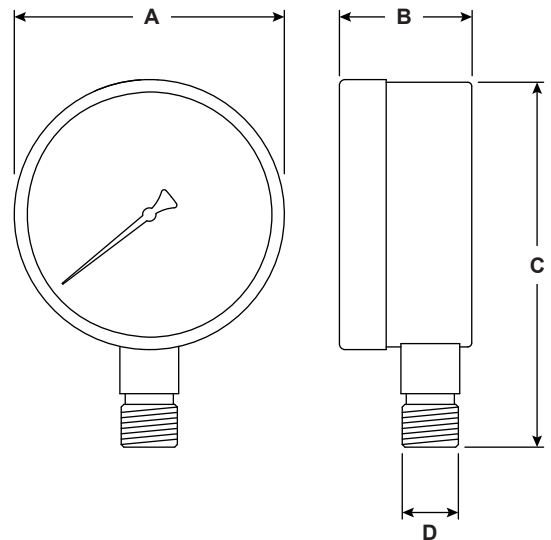

Needle valve				
DN	A	B	C	Weight
1/2"	75	30	90	0.460

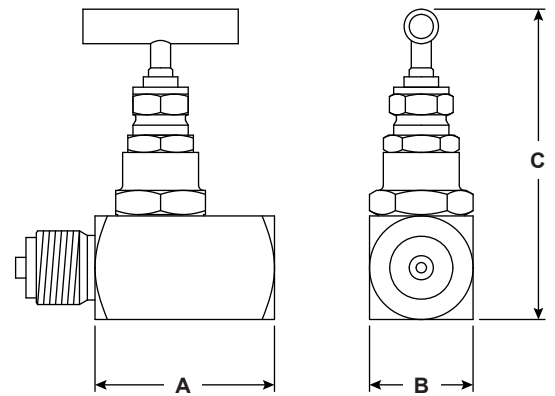

Ring syphon		
A	B	Weight
321	116	0.94

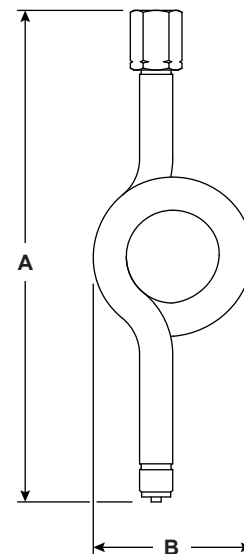

Safety information, installation and maintenance

For full details see the Installation and Maintenance Instructions (IM-P109-02) supplied with the product.

Installation note:

As with all instrumentation, the Spirax Sarco pressure gauge is a delicate measuring device and care has to be taken in its installation and use if it is to remain reliable.

It is recommended that all gauges are fitted with a gauge cock to assist when calibration or maintenance is necessary. When used on steam or other hot gases, gauges must be protected from heat by the use of a ring syphon tube and needle valve. The syphon pipe should be primed with water prior to fitting the gauge. Care should be taken if the installation is exposed to frost as gauges can burst.

Disposal:

The product is recyclable. No ecological hazard is anticipated with the disposal of this product providing due care is taken, with the exception of PTFE (ball valves).

PTFE:

- Can only be disposed of by approved methods, not incineration.
- Keep PTFE waste in a separate container, do not mix it with other rubbish, and consign it to a landfill site.

How to order

Example: 1 off Spirax Sarco 4" pressure gauge with a pressure range of 0 - 10 bar and having screwed ½" BSPP connections.

Spare parts

There are no spare parts available for Spirax Sarco pressure gauges.

Typical uses of a ring syphon and gauge

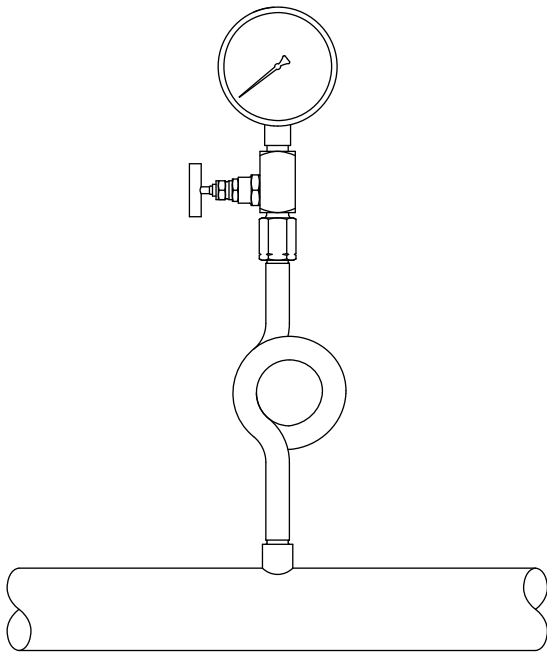

Horizontal pipe (where headroom allows)

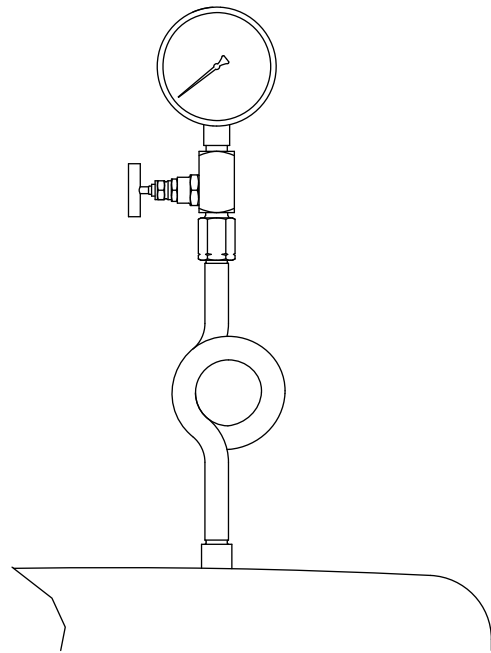

Top of vessel