



SIB30 and SIB30H Stainless Steel Sealed Inverted Bucket Steam Traps

Description

The SIB30 and SIB30H are all stainless steel sealed inverted bucket steam traps.

Standards

These products fully comply with the requirements of the Pressure Equipment Directive (PED)

Certification

This product is available with certification to EN 10204 3.1.

Note: All certification/inspection requirements must be stated at the time of order placement.

Sizes and pipe connections

½" and ¾" screwed BSP or NPT.

DN15 and DN20 socket weld ends (BS 3799).

DN15 and DN20 flanged ASME 150, ASME 300 and EN 1092 PN40 as standard. Alternative flanges are also available, on request, with JIS tables 20, 16 and 10 connections.

Materials

| No. | Part | Material | |
|-----|---------------|-----------------|------------------------|
| 1 | Cover | Stainless steel | ASTM A240 Gr. 304 |
| 2 | Body | Stainless steel | A182 F304 |
| | Flanges | Carbon steel | Mat No. 1.0460 (C22.8) |
| 3 | Bucket | Stainless steel | BS 1449 321 S 12 |
| 4 | Pivot pin | Stainless steel | BS 970 304 S 15 |
| 5 | Valve seat | Stainless steel | AISI 440B |
| 6 | Valve | Stainless steel | AISI 440B |
| 7 | Valve lever | Stainless steel | BS 1449 321 S 12 |
| 8 | Internal tube | Stainless steel | BS 3605 304 S 14 |

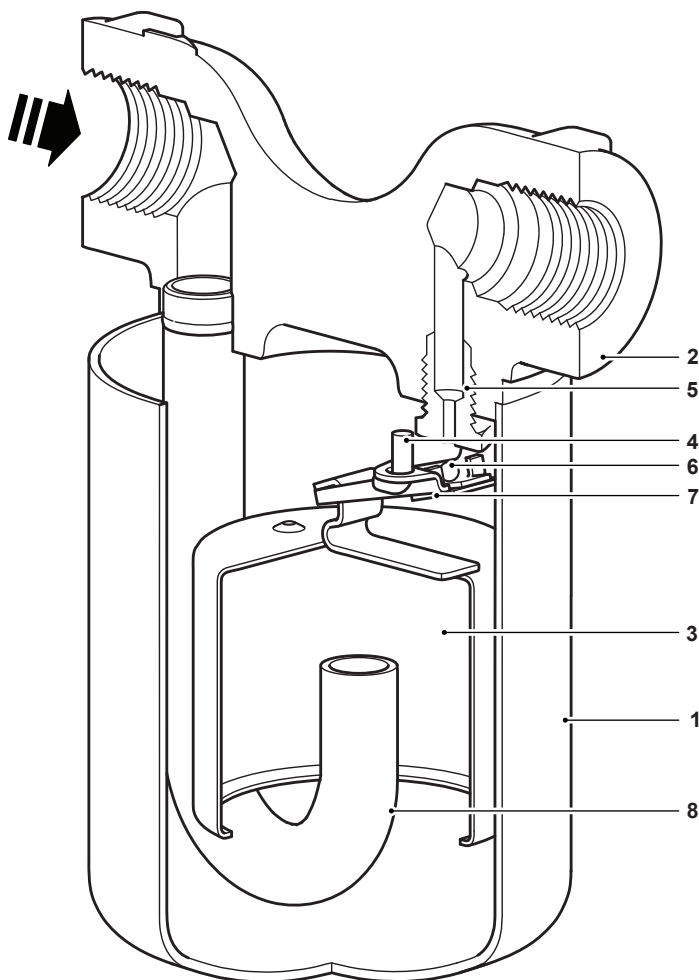

Pressure/temperature limits (ISO 6552)

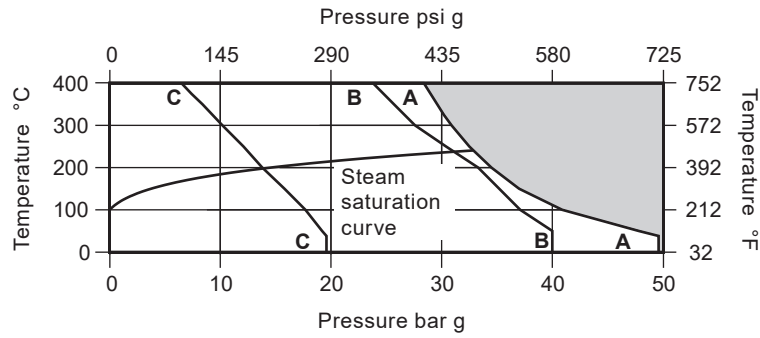

The product **must not** be used in this region.

A - B Flanged ASME 300, screwed and socket weld

A - C Flanged EN 1092 PN40

A - D Flanged ASME 150

| Body design condition | | PN50 | | |
|--|--|-------------------|--------------------|------------------|
| PMA | Maximum allowable pressure | 49 bar g @ 38 °C | 711 psi g @ 100 °F | |
| TMA | Maximum allowable temperature | 400 °C @ 28 bar g | 752 °F @ 406 psi g | |
| Minimum allowable temperature | | -29 °C | -20.2 °F | |
| PMO | Maximum operating pressure for saturated steam service | 30 bar g | 435 psi g | |
| TMO | Maximum operating temperature | 400°C @ 28 bar g | 752 °F @ 406 psi g | |
| Minimum operating temperature | | 0 °C | 32 °F | |
| Note: For lower operating temperatures consult Spirax Sarco | | | | |
| | | 30.0 | SIB30/4 | SIB30H/5 |
| | | 20.0 | SIB30/5 | SIB30H/6 |
| | | 12.0 | SIB30/6 | SIB30H/7 |
| | | 8.5 | SIB30/7 | SIB30H/8 |
| ΔPMX | Maximum differential pressure | 5.0 | - | SIB30H/10 |
| | | 4.0 | SIB30/8 | - |
| | | 2.5 | SIB30/10 | - |
| | | 2.0 | - | SIB30H/12 |
| | | 1.5 | SIB30/12 | - |
| Designed for a maximum cold hydraulic test pressure of | | 75 bar g | 5.17 psi g | |

Capacities

Note: A trap should be selected for the most appropriate working pressure differential and not on the basis of load, e.g. 80 kg/h at 7 bar differential should be handled with the SIB30/7 and not the SIB30/4.

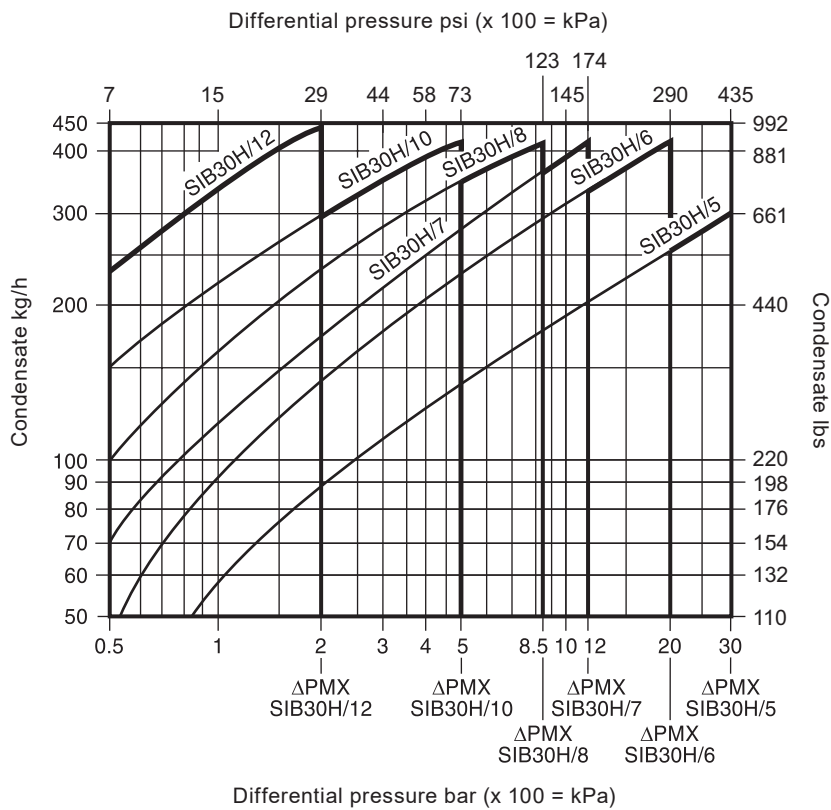
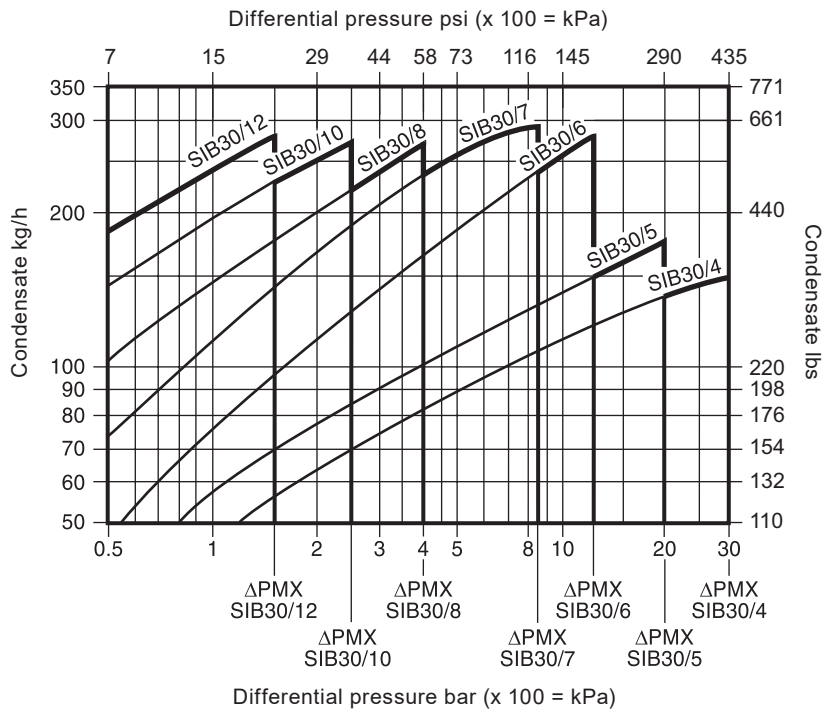

Dimensions/weights (approximate) in mm (inches) and kg (lbs)

SIB30

| Size | A | A1 | B | C | D | Weight | |
|-------------|--------|--------|-------|--------|--------|--------|--------|
| | | | | | | Scr/SW | Flg |
| DN15 - 1/2" | 110 | 150 | 76 | 124 | 143 | 1.5 | 2.9 |
| DN20 - 3/4" | (4.33) | (5.91) | (3.0) | (4.88) | (5.63) | (3.31) | (6.39) |

SIB30H

| Size | A | A1 | B | C | D | Weight | |
|-------------|--------|--------|-------|--------|--------|--------|--------|
| | | | | | | Scr/SW | Flg |
| DN15 - 1/2" | 110 | 150 | 76 | 159 | 177 | 1.75 | 3.15 |
| DN20 - 3/4" | (4.33) | (5.91) | (3.0) | (6.26) | (6.97) | (3.86) | (6.94) |

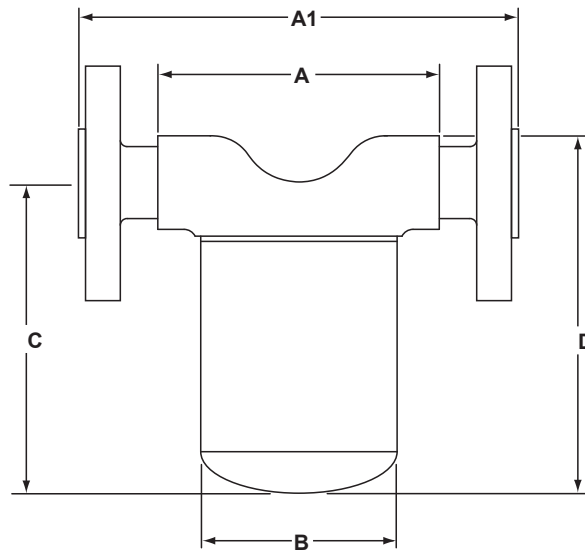

Safety information, installation and maintenance

For full details see the Installation and Maintenance Instructions (IM-P110-05) supplied with the product.

Installation note:

Install in a horizontal pipe, below the drain point. If installed in exposed positions, consideration should be given to insulating the trap.

How to order

Example: 1 off Spirax Sarco 1/2" screwed BSP SIB30/6 sealed inverted bucket steam trap.

Note: The cover (and flanges when specified) are welded to the body using the TIG process. Welds are approved in accordance with ASME section IX and BS EN 288.