

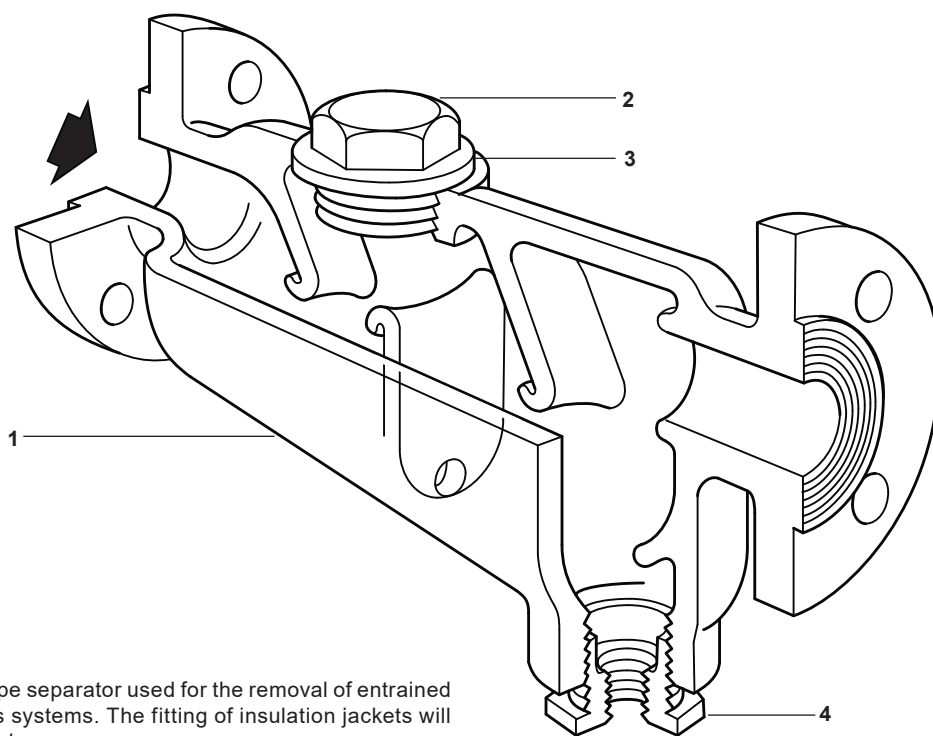

S3

Cast Iron Separator (Flanged)



Description

The S3 separator is a cast iron baffle type separator used for the removal of entrained liquids in steam, compressed air or gas systems. The fitting of insulation jackets will increase the performance of the separator.

Standards

This product fully complies with the requirements of the Pressure Equipment Directive (PED).

Certification

This product is available with a manufacturers' Typical Test Report.

Note: All certification/inspection requirements must be stated at the time of order placement.

Sizes and pipe connections

DN40, DN50, DN65, DN80, DN100, DN125, DN150 and DN200
Flanged EN 1092 PN16 with screwed BSP drain,
ASME Class 125 with screwed NPT drain,
JIS/KS 10K with screwed BSP drain, and
AS2129 Table F with screwed BSP drain (DN40 to DN100 only).

Materials

No. Part	Material
1 Body	Cast iron ASTM A126 CI B
2 Plug	SG iron DIN 1693 GGG 40
3 Gasket	Reinforced exfoliated graphite
4 Drain reducing bush (not DN200)	Steel ASTM A105

Pressure/temperature limits (ISO 6552)

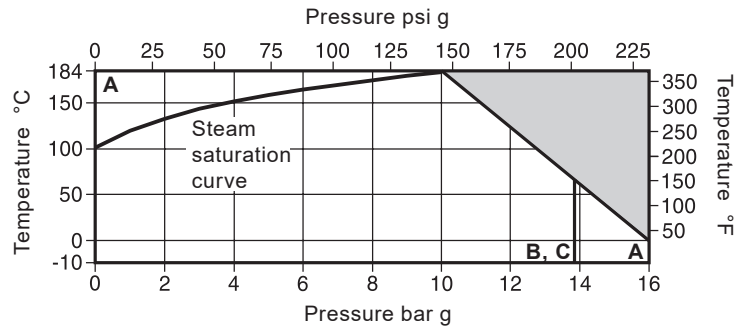

The product **must not** be used in this region.

A - A Flanged EN 1092 PN16, Table F and screwed BSP or NPT.

A - B Flanged JIS/KS 10K.

A - C Flanged ASME Class 125.

Body design conditions		PN16	
PMA	Maximum allowable pressure	16 bar g @ 0 °C	(232 psi g @ 32 °F)
TMA	Maximum allowable temperature	184 °C @ 10 bar g	(363 °F @ 145 psi g)
	Minimum allowable temperature	-10 °C	(14 °F)
PMO	Maximum operating pressure for saturated steam service	10 bar g	(145 psi g)
TMO	Maximum operating temperature	184 °C @ 10 bar g	(363 °F @ 145 psi g)
	Minimum operating temperature	-10 °C	(14 °F)
Note: For lower operating temperatures consult Spirax Sarco.			
Designed for a maximum cold hydraulic test pressure of:		24 bar g	(348 psi g)

Note: Flanged separators (S3) may be supplied with a lower pressure rating than that cast into the body. Reference should be made to the appropriate operating chart to determine the actual product limitations.



Dimensions/weights and volumes (approximate)

mm, kg and litres	Size	A	B	C	D	E	F	G	Weight	Volume
	DN40	111	156	89	365	12.7	38.1	94	14.0	1.6
	DN50	146	206	117	456	12.7	38.1	98	25.4	3.2
	DN65	184	232	146	406	19.0	38.1	98	36.7	4.6
	DN80	187	264	152	483	25.4	38.1	98	44.9	6.5
	DN100	238	337	197	692	25.4	38.1	118	74.8	13.5
	DN125	232	409	381	706	25.4	38.1	121	177.8	38.5
	DN150	232	409	381	706	25.4	38.1	121	181.4	42.5
	DN200	305	505	426	762	38.1	38.1	140	254.0	68.0

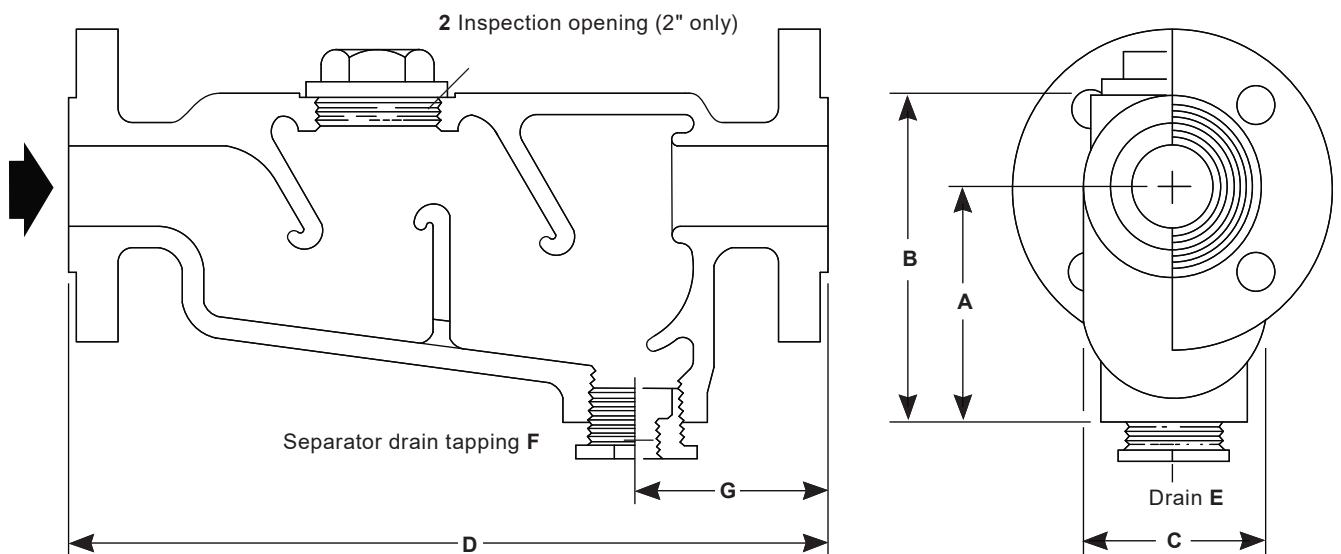
inches, lbs and gallons	Size	A	B	C	D	E	F	G	Weight	Volume
	DN40	4.37	6.14	3.50	14.3	½"	1½"	3.70	30.8	0.42
	DN50	5.74	8.11	4.60	17.9	½"	1½"	3.85	55.9	0.80
	DN65	7.24	9.13	5.74	15.9	¾"	1½"	3.85	80.9	1.21
	DN80	7.36	10.3	5.98	19.0	1"	1½"	3.85	98.9	1.71
	DN100	9.37	13.2	7.75	27.2	1"	1½"	4.64	164.9	3.56
	DN125	9.13	16.1	15.0	27.7	1"	1½"	4.76	391.9	10.1
	DN150	9.13	16.1	15.0	27.7	1"	1½"	4.76	400.0	11.2
	DN200	12.00	19.8	16.7	30.0	1½"	1½"	5.51	560.0	17.9



Recommended tightening torques

Item	Size	or		N m	(lbf ft)
					
2	DN40	46 A/F	M56	150 - 165	(110 - 121)
	DN50	60 A/F	M72	190 - 210	(140 - 155)
	DN65	46 A/F	M56	150 - 165	(110 - 121)
	DN80	60 A/F	M72	190 - 210	(140 - 155)
	DN100	60 A/F	M72	190 - 210	(140 - 155)
	DN125	60 A/F	M72	190 - 210	(140 - 155)
	DN150	60 A/F	M72	190 - 210	(140 - 155)
	DN200	60 A/F	M72	190 - 210	(140 - 155)

Safety information, installation and maintenance

For full details see the Installation and Maintenance Instructions (IM-P023-55) supplied with the product.

Installation note:

Install in a horizontal pipeline with the drain directly below. Note: To ensure that any separated liquid is drained away quickly, a suitable liquid drainer or steam trap must be connected to the drain connection 'E' - consult Spirax Sarco for further details.

Disposal

This product is recyclable. No ecological hazard is anticipated with the disposal of this product, providing due care is taken.

How to order

Example: 1 off DN50 Spirax Sarco S3 separator with cast iron body having flanged EN 1092 PN16 connections.