



Cert. No. LRQ 0963008

ISO 9001

spirax sarco

TI-P603-04
ST Issue 2

FT54

Carbon Steel Ball Float Steam Trap with Flanged Connections - DIN (Spares)

DN15 FT54V (vertical) shown

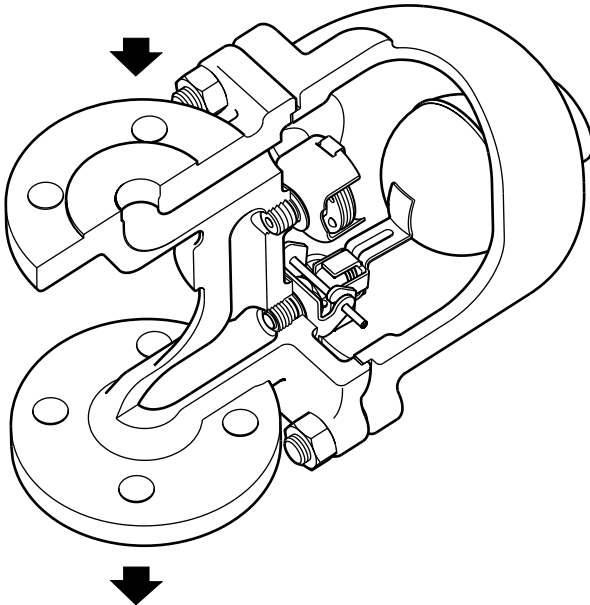

Traps having the optional steam lock release will have the nomenclature:-
FT54V-C or FT54H-C

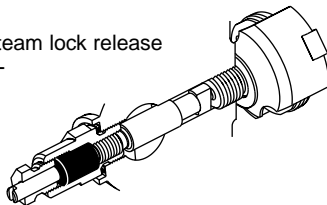

DN40 FT54H (horizontal) shown

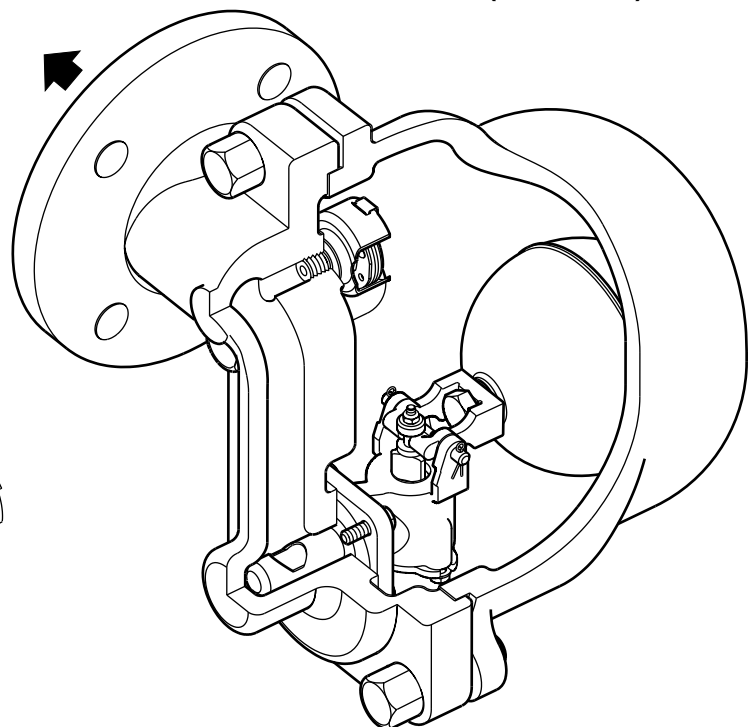

Safety information

Pressure

Before attempting any maintenance on the trap, consider what is or may have been in the pipeline. Ensure that any pressure is isolated and safely vented to atmospheric pressure before attempting to maintain the steam trap. This is easily achieved by fitting Spirax Sarco depressurisation valves type DV (see separate literature for details). Do not assume that the system is depressurised even when a pressure gauge indicates zero.

Temperature

Allow time for temperature to normalise after isolation to avoid the danger of burns and consider whether protective clothing (including safety glasses) is required.

Caution: The cover gasket and main valve assembly gasket may contain a thin stainless steel support ring which may cause physical injury if it is not handled and disposed of carefully.

Installation

The trap is designed for installation with the float arm in a horizontal plane so that it rises and falls vertically, ideally with a drop leg immediately preceding the trap. Suitable isolation valves must be installed to allow for safe maintenance/replacement. Remove all protective caps prior to installation. Open isolation valves slowly and check for leaks. Where steam traps are fitted in exposed conditions, the possibility of freezing damage may be reduced by thermal insulation/draining/isolation.

Maintenance

Maintenance can be completed with the trap in the pipeline, once the safety procedures have been observed. It is recommended that new gaskets and spares are used whenever maintenance is undertaken. Ensure that the correct tools and necessary protective equipment are used at all times. When maintenance is complete open isolation valves slowly and check for leaks. See IM-P603-03 for further details.

Disposal

No ecological hazard is anticipated with the disposal of this product provided due care is taken.

*Local regulations may restrict the use of this product to below the conditions quoted.
In the interests of development and improvement of the product, we reserve the right to change the specification.*

© Copyright 2004

Spare parts

The spare parts available are shown in solid outline. Parts shown in broken line are not supplied as spares. For further technical information see TI-P603-01.

Available spares

Main valve assembly with float (DN15, DN20 and DN25)	5, 6, 10, 12, 13, 14, 15
Main valve assembly with erosion deflector (DN40 and DN50)	7, 8, 9, 16
Ball float (DN40 and DN50 only)	11
Air vent assembly	17, 18
Complete set of gaskets (packet of 3)	3, 9, 18, 20
Steam lock release and air vent assembly	17, 18, 19, 20, 21, 22, 23

How to order spares

Always order spare parts by using the description given in the column headed 'Available spares' and state the size, Model No., orientation i.e. horizontal (H) or vertical (V) and pressure rating of the trap.

Example: 1 - Main valve assembly for a DN40 FT54H-4.5 ball float steam trap. For operating pressures up to 4.5 bar.

Note: If the product has the optional steam lock release fitted the nomenclature would be FT54H-4.5-C.

FT54H shown

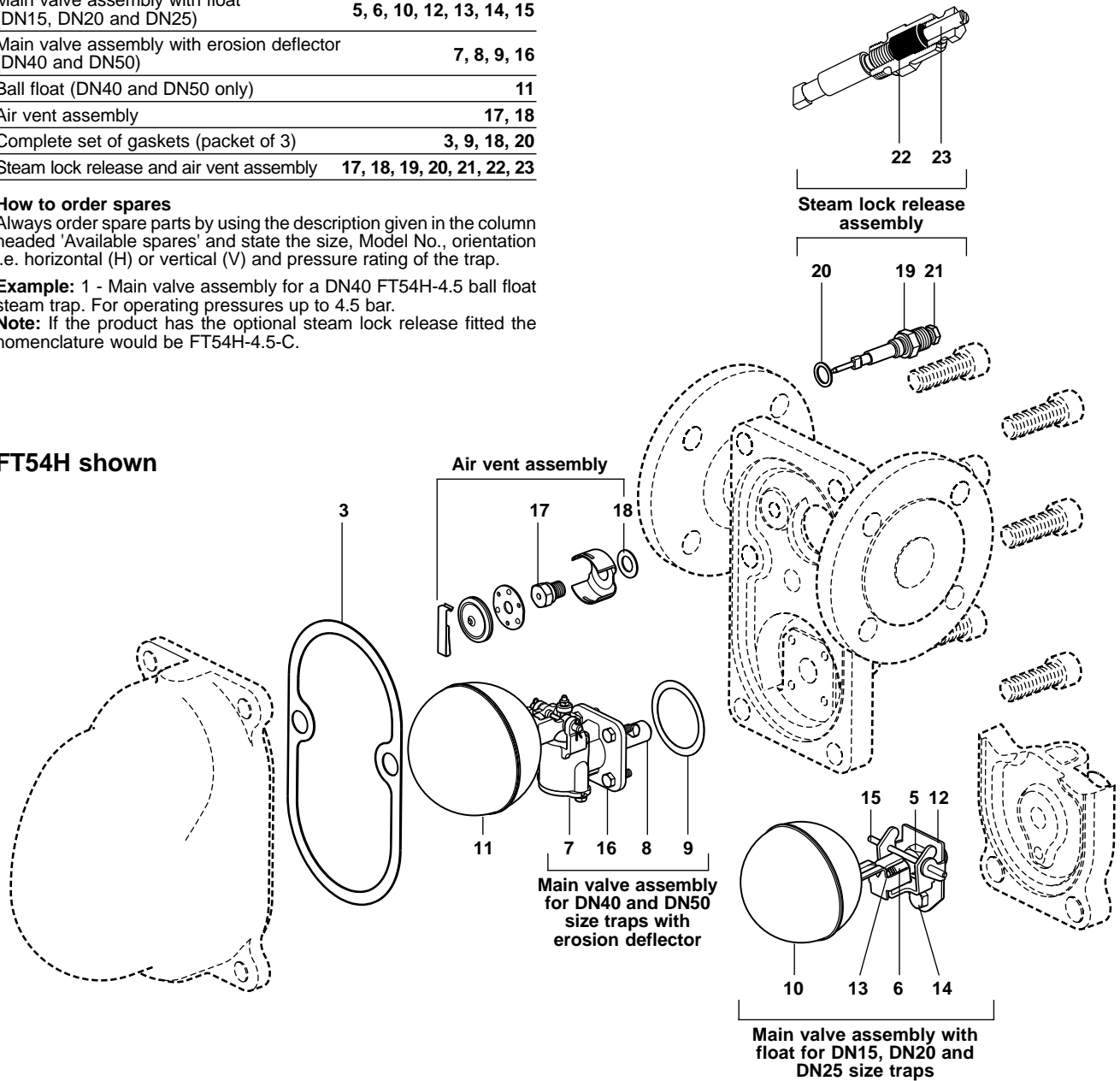

Recommended tightening torques

Item			or mm		N m	
4	DN15, DN20 and DN25	FT54H	Bolt	10 (socket)	M12 x 35	70-75
		FT54V	Stud		M12	35-40
	DN40 and DN50	FT54H	Nut	19	M12	70-75
		FT54H	Bolt	24	M16 x 55	150-165
		FT54V	Stud		M16	70-80
		FT54V	Nut	24	M16	150-165
5			17	M12	50-55	
14			10	M6 x 10	10-12	
16			10	M6 x 10	10-12	
17			17		50-55	
19	(SLR sub-assembly)		19		40-45	
21	(SLR retaining nut)		13		4-5	