

Internal Strainer for the DP17, DP27 and 37D Pilot Operated Pressure Reducing Valves Installation and Maintenance Instructions

Warning

For the full Installation and Maintenance Instructions, inclusive of safety information, see the relevant documents supplied with the product and listed below:

Valve type	IM reference no.
DP17, DP17E, DP17G, DP17R and DP27G	IM-P100-05
DP17T and DP17TE	IM-P101-04
DP27, DP27E and DP27R	IM-P470-03
DP27T	IM-P470-09
37D and 37DE	IM-P102-04

Note:

Installation and Maintenance Instructions are available separately from Spirax Sarco.

Fitting instructions

For the DP17 and all variants except the DP17R and 37D:

- Isolate the pressure reducing valve and zero the pressure.

For the DP17R and DP27R (not shown):

- Isolate the actuating air supply and zero the pressure.

For the 37D (not shown):

- Allow the sensor bulb to cool before dismantling the valve.

For the DP27 and all variants except the DP17R and DP27R:

- Isolate the reducing valve and zero the pressure.

1. Release the lock-nut.
2. Turn the adjustment screw anticlockwise. Ensure there is no compression on the pressure adjustment spring
3. Slide out the 'C' washer.
4. Remove the cover.
5. **For the DP17 and all variants:**
 - Remove the pressure adjustment spring and top plate.

For the DP27 and all variants:

- Undo the 4 off spring housing securing nuts and remove the spring housing.
- Remove the pressure adjustment spring and the top spring plate.

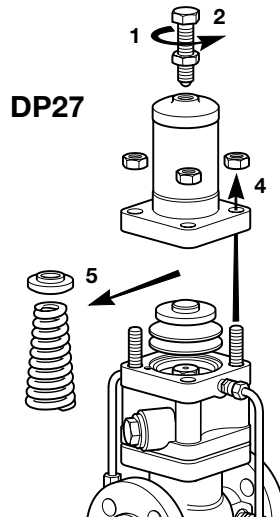
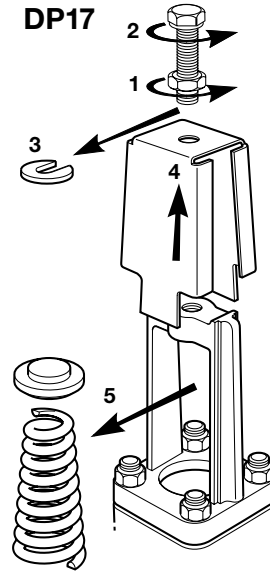

6. Unscrew the unions and release the pipework.
7. Unscrew the nuts. Note that this has already been actioned under Step 5 for the DP27 and variants.
8. Remove the pilot valve housing.

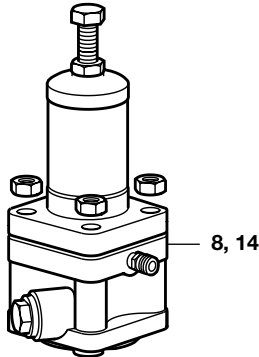

DP27 pilot valve housing

9. Remove the main valve screen.
10. Ensure the gasket faces are clean.
11. Ensure that the main valve return spring is still in position.
12. Fit new gasket.

Safety note: Care should be exercised when handling gaskets since the stainless steel reinforcing strip can easily inflict cuts.

13. Replace the main valve screen.

14. **For the DP17, DP27 and all variants except the DP17R, DP27R and 37D** - Assemble the pilot valve housing complete with spring housing assembly and tighten the nuts to the recommended tightening torques shown in Table 1.

For the DP17R and DP27R - Assemble the pilot valve housing complete with the air control block and tighten the nuts to the recommended tightening torques shown in Table 1.

For the 37D - Assemble the pilot valve housing complete with the temperature control system and tighten the nuts to the recommended tightening torques shown in Table 1.

15. Refit the pipework and retighten the unions to ensure a tight seal.
16. Reassemble in reverse order.

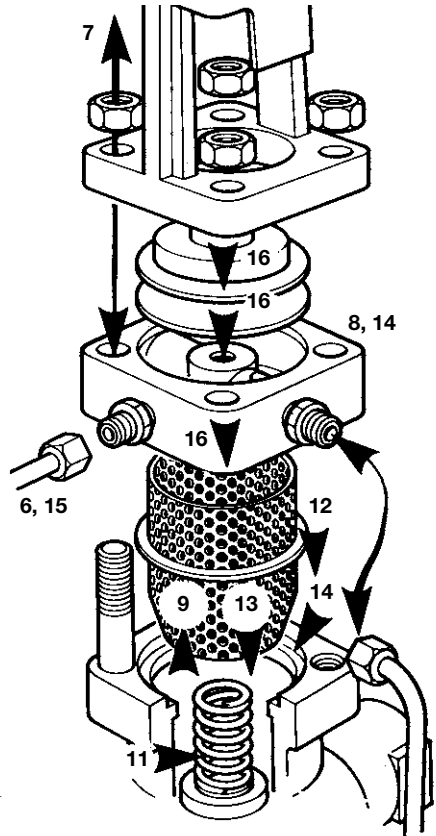

DP17 shown

The valve can now be brought back into commission.

Table 1 Recommended tightening torques

Size of valve	Nut size	Tightening torques	
		N m	(lbf ft)
DN15, DN20, DN25 and DN32	M10	40 - 50	(30 - 37)
DN40 and DN50	M12	45 - 55	(33 - 40)